

2) Connect two wires to branch circuit L and N according to the below figure.

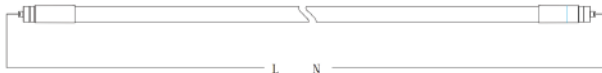

Input voltage:120-277V 50/60Hz

R17D



Input voltage:120-277V 50/60Hz

FA8

4. INSERT LED TUBES

a. Insert LED lamp in the normal way by sliding pins into sockets until LED tube locks in place as below.

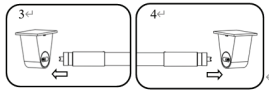

- b. Clip the anti-rotating clip on the middle of the tube and make sure it is attached to the fixture to prevent tube droop and rotation.
- c. LED lamps are now fully installed.
- d. Replace troffer lens, if present.
- e. After modification completed. Attach the Replacement Marking and cautionary Label to a visible place on the luminaire and keep it visible after installation.

5. RESTORE THE POWER OF LUMINAIRE

Restore power to circuit/luminaire and test light. If necessary, adjust position of LED tube, and enjoy your new LED tube light!

Ballast Compatibility List

RISK OF FIRE: Check the Ballast Compatible List before installing this retrofit kit to the fixtures with electronic ballast. **DO NOT** install this kit to the fixture if the ballast is not in the list. In this instance, please bypass the ballast or confirm with the supplier.

No. Ballast Brand Model No.

1	ACT	ACT2P59ISUNV	8	ULTRAMAX	GE-159-MAX-N/Ultra
2	Halco	EP259IS/MV	9	OSRAM	QHE 2X59T8/UNV ISN-SC
3	Halco	EP2/59ISMV/MC/HE	10	OSRAM	QTP 2X59T8/UNV ISN-SC
4	ULTRA START T8	GE259MAX-L/ULTRA	11	SYLVANIA	QHE 2X59T8/UNV ISL-SC
5	UltraMaxG-SeriesT8	GE259MAX-G-N-DIYB	12	ESPEN	VE259MVHIP11103
6	PHILIPS ADVANCE	IOP-2P59-N	13	ESPEN	VE259120HIP
7	Traid	B259IUNVHP-A			

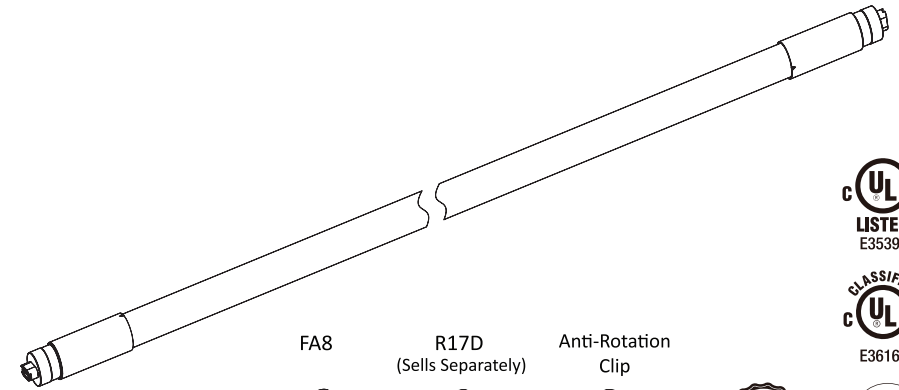

FA8



R17D
(Sells Separately)



Anti-Rotation
Clip



Each Retrofit kit consists of LED tube lamp, installation instruction (1 pcs), R17D adaptor(2pcs) and Fixed anti-rotating clip(1pcs).

R17D adaptor is used for R17D to G13 conversion

FA8 adaptor is used for FA8 to G13 conversion (Sells Separately)

Anti-rotating clip is used for fixing it in the middle of the tube to prevent tube droop and rotation.

MARKINGS/WARNING:

MARKINGS/WARNING:

- a. Risk of fire or electric shock. When work with electronic ballast please check the compatible list first! If you do not find your ballast on the list then please bypass the fixture, or please contact us! Do not install the LED tube with the ballast which not on the ballast compatible list, risk of firing!
- b. Risk of fire or electric shock. LED Retrofit Kit installation requires knowledge of luminaires electrical systems. If not qualified, do not attempt installation. Contact a qualified electrician.
- c. Risk of fire or electric shock. Install this kit only in the luminaires that have the construction features and dimensions shown in the photographs and/or drawings and where the input rating of the retrofit kit does not exceed the input rating of the luminaire.
- d. Do not make or alter any open holes in an enclosure of wiring or electrical components during kit installation
- e. To prevent wiring damage or abrasion, do not expose wiring to edges of sheet metal or other sharp objects.
- f. To avoid potential fire or shock hazard, do not use this retrofit kit in luminaires employing shunted bi-pin lamp holders. Note: Shunted lamp holders are found only in fluorescent luminaires with Instant-Start ballasts. Instant-start ballasts can be identified by the words "Instant Start" or "I.S." marked on the ballast. This designation may be in the form of a statement pertaining to the ballast itself, or may be combined with the marking for the lamps with which

the ballast is intended to be used, for example F40T12/IS. For more information, contact the LED luminaire retrofit kit manufacturer.

g. Installers should not disconnect existing wires from lamp holder terminals to make new connections at lamp holder terminals. Instead installers should cut existing lamp holder leads away from the lamp holder and make new electrical connections to lamp holder lead wires by employing applicable connectors.

h. For a linear tubular LED lamp conversion, there shall be text or a diagram showing how the supply connections were made to the lamp holders so the correct connections will be made to the lamp when the lamp is installed or replaced.

i. This retrofit kit is accepted as a component of a luminaire where the suitability of the combination shall be determined by authorities having JURISDICTION.

j. If the tube is installed as Type B, the luminaire, once modified as retrofit fixture, will no longer operate fluorescent lamps. Not suitable for use with Dimmer.

T8 8FT LED Tube - Assembly introduction:

1. Confirm the type of lamp holder of the fixture (Fa8 or R17d)
2. Choose Fa8 or R17d adaptor which matches the lamp holder of fixture, and assemble the adaptor end cap to the tube.

Integrated 8ft LED tube



R17D



Fa8

Type A Installation introduction:

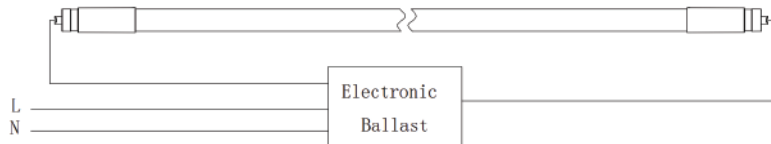

R17D

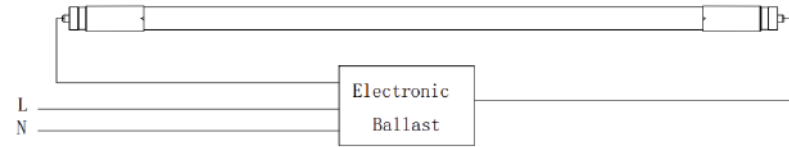

Fa8

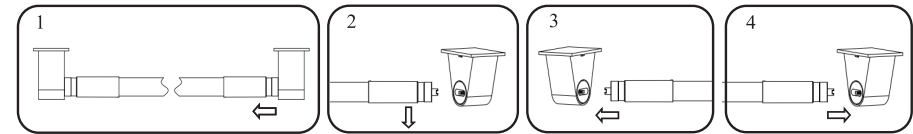

Instructions

1. Switch-off power to the luminaire.
2. Remove diffuser (if provided).
3. Remove the existing fluorescent lamps from the luminaire.
4. Install the LED tube lamp.
5. Clip the anti-rotating clip on the middle of the tube and make sure it is attached to the fixture to prevent tube droop and rotation.
6. Install diffuser (if removed in step 2).
7. Switch on power to the luminaire.
8. Before installation, please check specifications for the most current ballast compatibility list, if no match, please insert led tubes according to below type B installation instructions.

Type B Installation introduction:

1. DISCONNECT POWER OF LUMINAIRE.
Disconnect power to luminaire or circuit (if possible). Ensure all power is off by using a voltmeter or other method to confirm.
2. REMOVE EXISTING TUBE LAMP(S)
 - a. Remove troffer lens, if present.
 - b. Remove existing fluorescent as below.

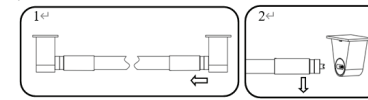

- c. Remove ballast cover. (Cover may be secured with screws or tabs).

3. REWIRE THE FIXTURE

- 1) Disconnect the wires between starter and ballast.